

Bally's Casino at Medinah Temple

Community Engagement Presentation

November 29, 2022

Today's Presenters



Christopher Jewett

Vice President,
Corporate Development

Bally's Corporation



Ameet Patel

Senior Vice President &
Regional GM, West

Bally's Corporation



Tim Doron

Senior Traffic Consultant

Fish Transportation



Luis Collado

Principal

STL Architects

Bally's Overview



Who We Are

- **20+ years** of retail and online casino operational experience
- **National database** connecting customers across our omni channel offering
- **High awareness** of Bally's brand that will continue to grow with our media and content partnerships
- **17 casinos** and **resorts** across **11 states**



Evolution Into a Premier Gaming Leader



Bally's Casino at Medinah Temple Overview



Bally's Casino at Medinah Temple



Bally's Casino at Medinah Temple - Site View

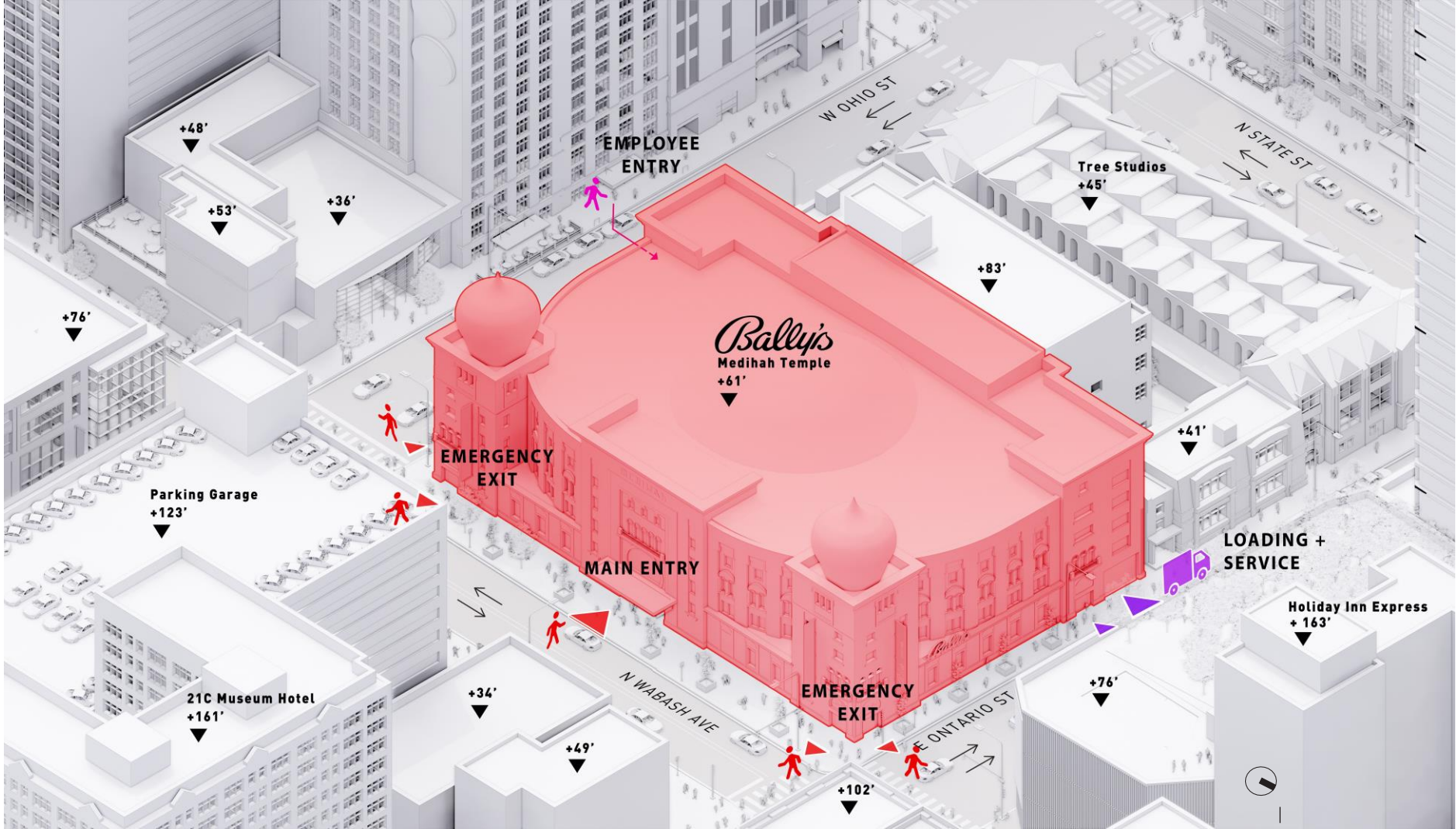

Bally's Casino at Medinah Temple - Program Plans

First Level

Second Level

Third Level

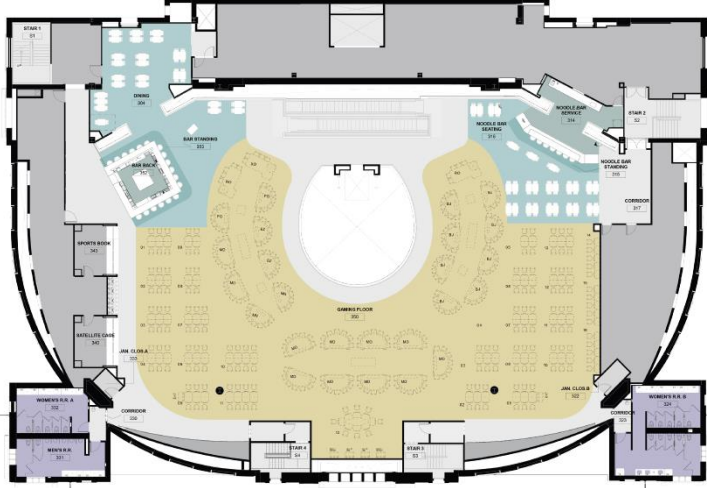
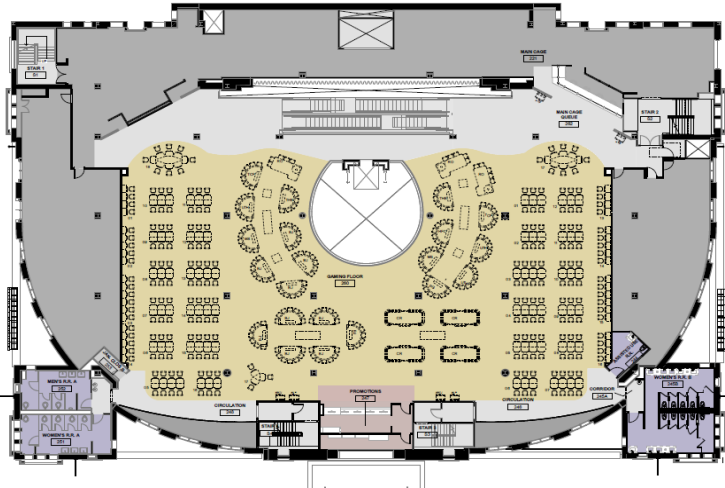
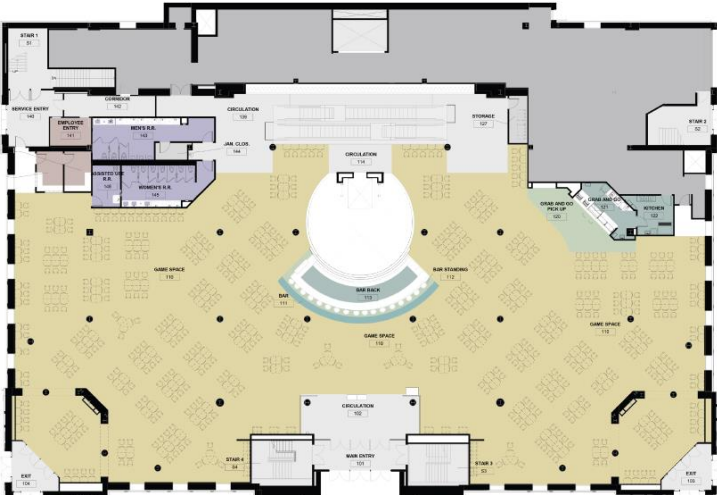

Bally's Casino at Medinah Temple - Cross Section View

EXISTING BUILDING

NEW INTERIOR PARTITIONS

NEW INTERIOR FURNITURE + EQUIPMENT



Bally's Casino at Medinah Temple - Showcase Central Bar



Bally's Casino at Medinah Temple - Third Floor Bar / Restaurant



Bally's Casino at Medinah Temple - Operational Overview

Patron experience thoughtfully curated to provide top-notch experience

- Historical aspects of the Medinah Temple to remain untouched
- Three floors of unique gaming experience including over 800 slot machines and 50 table games
 - Examples include blackjack, roulette, craps, and baccarat
- Showcase center bar, 3-meal restaurant, and alternative quick serve food venues
- Variety of local food and beverage offerings to highlight Chicago's best

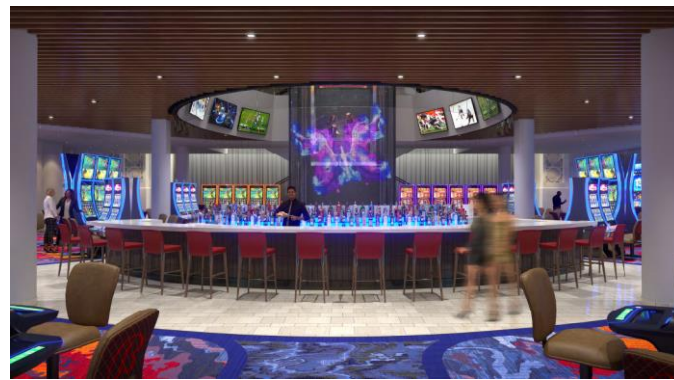

Best-In-Class Operational Safety Initiatives

Bally's will continue to collaborate with our community partners to provide a safe environment

Entering the Casino

- Single casino entrance check point vital to guest safety
- Mandatory identification check for all guests at entry point
- Mask down policy for identification validation and surveillance capture upon entry

Camera Monitoring Technology

- State-of-the art 24/7 gaming surveillance system with video retention
- Concealed weapons detection technology with added onboard cameras for close-up image capture
- Controlled / badged access to back-of-house areas

Exterior Security Measures

- High-tech video coverage around the casino security zone
- Daily management of pedestrian and vehicular traffic in coordination with OEMC
- Establish perimeter security posts on Wabash/State/Ohio/Ontario in conjunction with CPD assigned resources
- Increased coverage during peak volume and city/community wide event dates
- Private security roving / mobile patrol and communication with local law enforcement

Responsible Gaming Initiatives

\$200k annual commitment to responsible gaming programs

Promoting responsible gaming is our culture

- Enforcement set forth by Illinois Gaming Board
- IGB Statewide Voluntary Self-Exclusion Program
- Required annual employee training
- Materials available on-site and online for patrons
- Partner with local treatment partners
 - Division of Substance Use Prevention and Recovery
 - Illinois Council on Problem Gambling



**HAVE A
GAME PLAN[®]**
Bet responsibly.™

Human Resources Recruitment

"Dealing" Chicago Communities a Winning Hand...

Q4 2022 – "Buy In"

- Established
 - Bally's Chicago office location
 - Senior Leadership Onboarded
- Developed
 - Dealer School curriculum with City Colleges of Chicago partnership
 - Strategic recruitment & training plan

Q1 2023 – "Raise the Bet"

- Dealer School job information fairs
 - Focus on Craps, Blackjack & Roulette
- Dealer School Deals it's first hand
- Employment & Training Center Opens
- Recruiting efforts continue with host communities, Chicago residents and community based workforce organizations

Q2 2023 – "Jackpot"

- Casino Job Fair
- Rollout of Leadership Training Academy for all levels of management
- Onboarding of operation level positions

Development Approval Timeline

Medinah Temple is within an existing planned development with a permitted use for entertainment

Existing Planned Development

- Minor change approval from the Chicago Department of Planning and Development for signage
- Signage package nearly identical to previous Bloomingdale's

Landmark Building Approval

- Commission on Chicago Landmarks (August 4, 2022)
- Permit Review Committee (PRC) approval obtained for exterior signage and interior landmarked elements

Community Engagement Meetings

- Casino Town Hall Meeting (April 4, 2022)
- Casino Community Engagement Meeting (May 12, 2022)
- Temporary Casino Engagement Meeting (November 29, 2022)

Transportation Plan



Existing Roadway Configuration and Curb Space

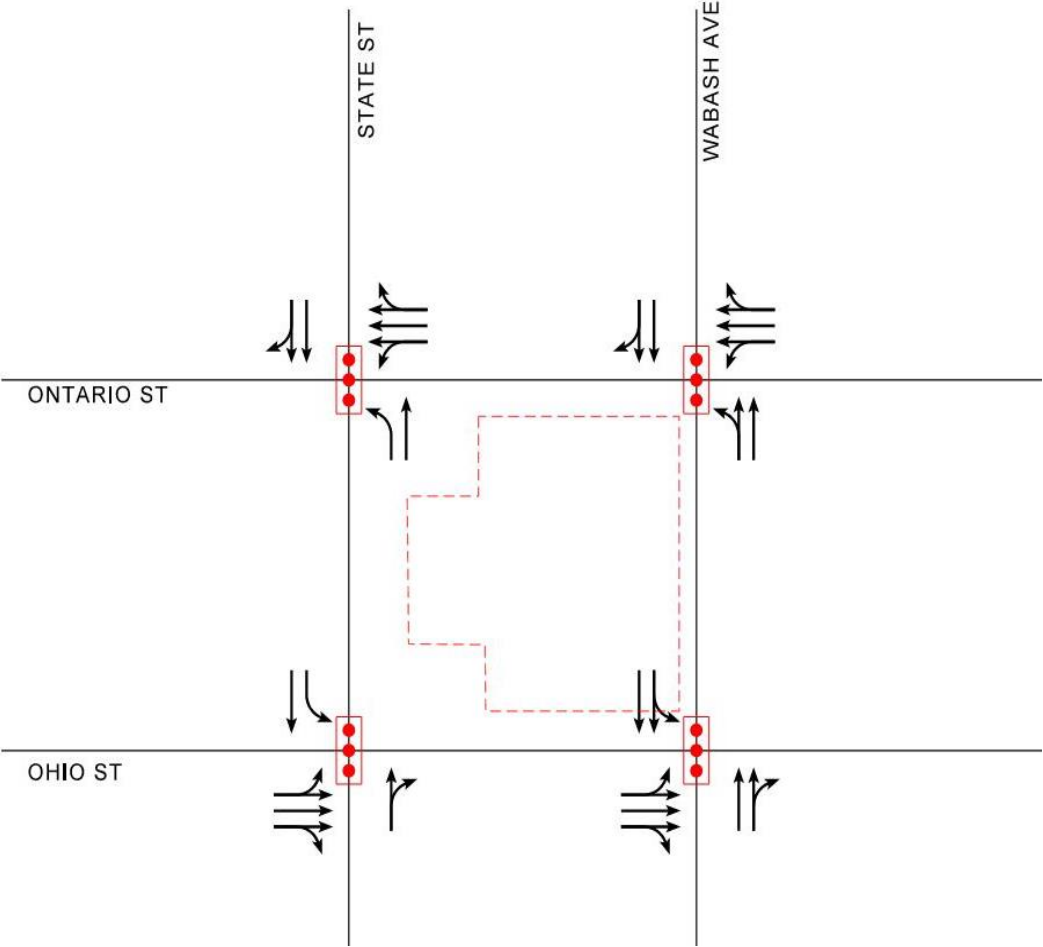

LEGEND

- NO PARKING
- PARKING ALLOWED
- NO PARKING
7 AM - 9 AM
4 PM - 6:30 PM
- MEDINAH TEMPLE
ENTRANCE
- BUS STOP
- 15 MINUTE
STANDING ZONE
- LOADING ZONE
- TAXI STAND
- VALET
- PARKING GARAGE
ACCESS

Site Volume by the Numbers

Traffic volumes are comparable to permitted PD uses¹

	Weekday Peak 4:00pm - 6:00pm		Friday Casino Peak 8:00pm - 11:00pm	
	Inbound	Outbound	Inbound	Outbound
Transit/Walk/Bike	50	42	48	56
Self Drive, Garage Park	110	98	107	126
Self Drive, Valet	37	33	36	41
Rideshare/Taxi	92	92	103	103



1. Restaurants and entertainment, medical offices, and retail

Convenient Parking Options

Nearly 5,000 garage spaces within walking distance

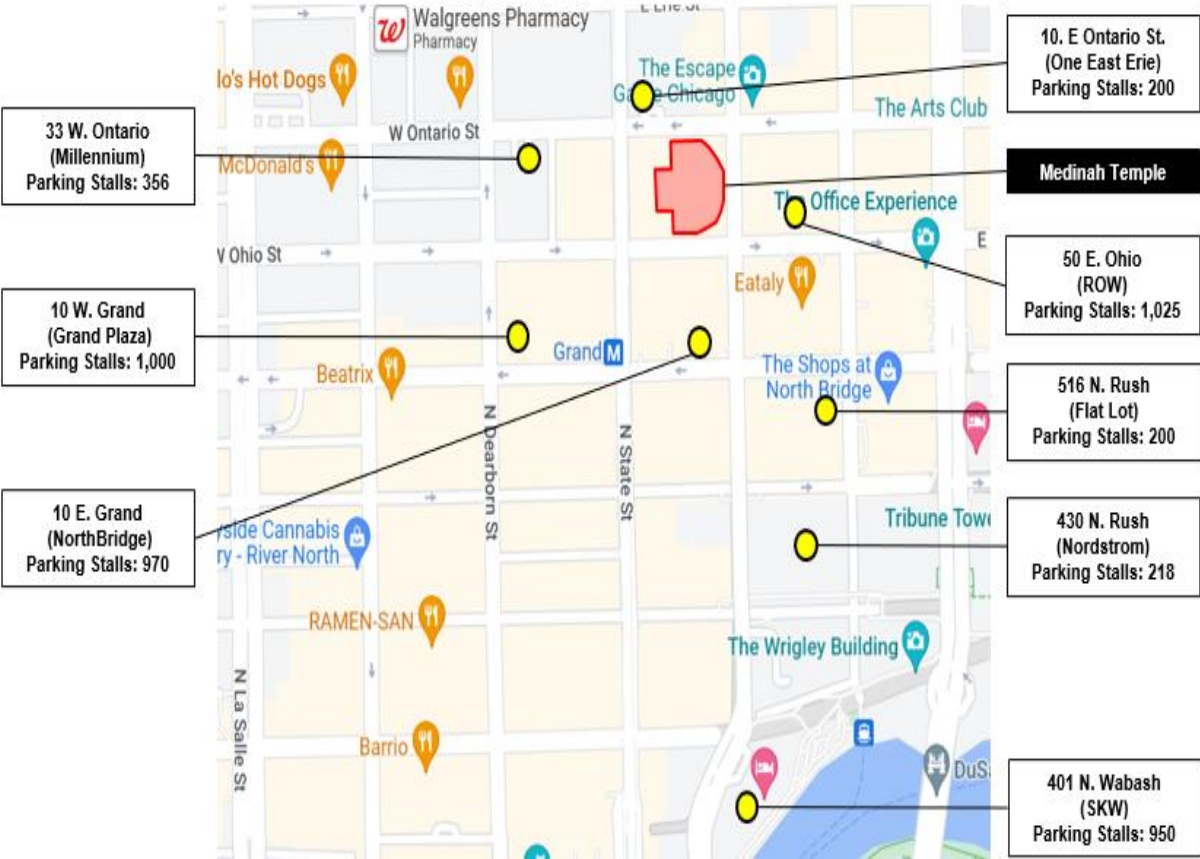

- Plentiful parking supply near Medinah Temple
- 10+ public transit stops within an approximate 2-block radius

Garage Location	Total # of Stalls
10 E. Grand	970
430 N. Rush	218
516 N. Rush	200
50 E. Ohio	1,025
10 W. Grand	1,000
33 W. Ontario	356
401 N Wabash	950
10 E. Ontario	200
Total # of Stalls	4,919

Proposed Curb Management Plan

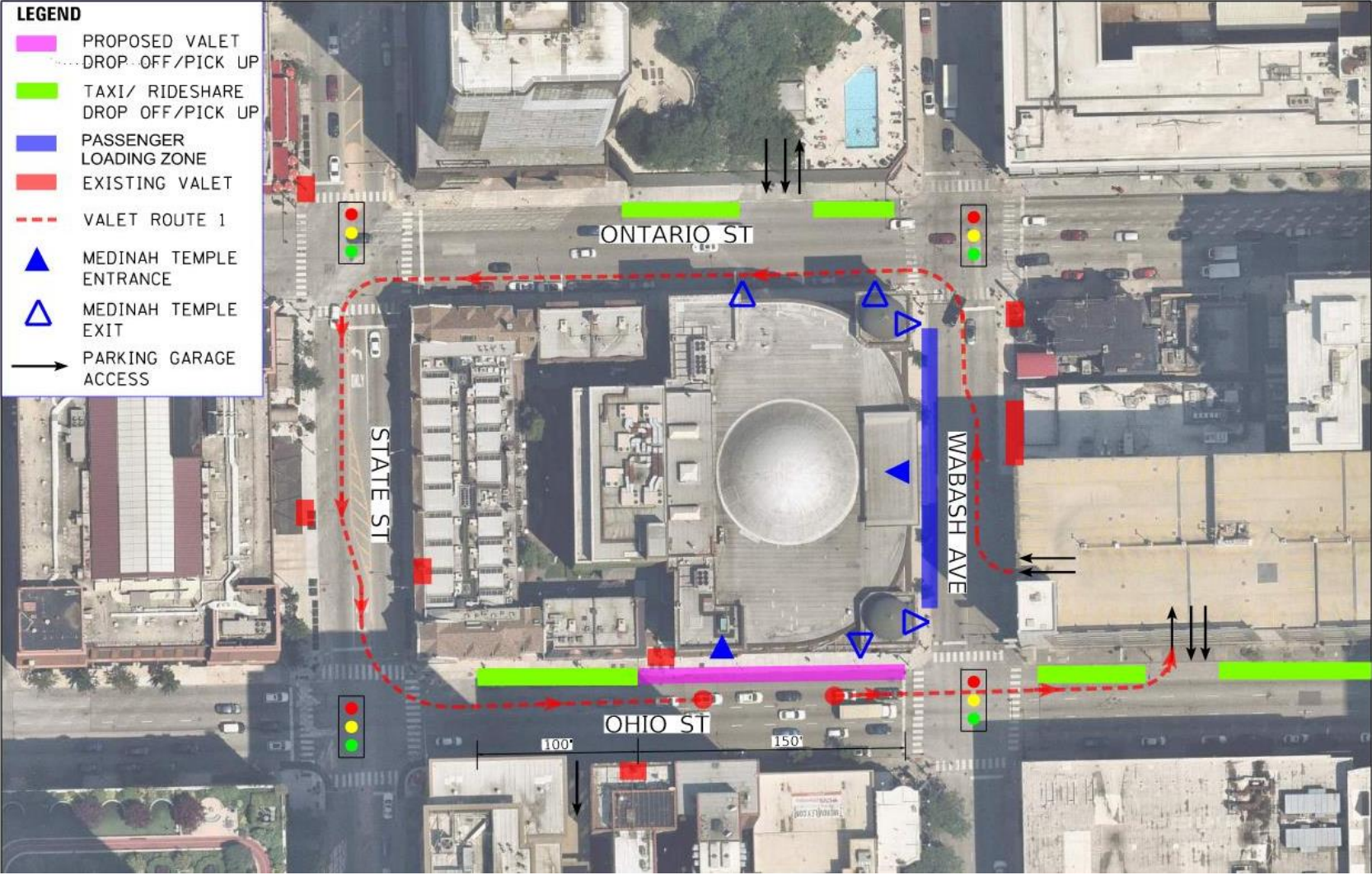

Bally's Commitments



Introductory Community Engagement Meetings

More than 50+ meetings to engage with the local community and representative organizations



Project Commitment & Goals

Monetary Payments	<ul style="list-style-type: none">• \$40 million upfront at signing of Host Community Agreement• \$2 million for community benefits + \$2 million for general fund annually
Minority & Women Ownership	<ul style="list-style-type: none">• 25% including a crowdfunding initiative
Jobs	<ul style="list-style-type: none">• 3,000 construction annually• 3,000 permanent
Design & Construction	<ul style="list-style-type: none">• 46% MBE / WBE with 50% total hours to City residents• LEED Gold, 125 points City Sustainable Development Policy• Temporary: 12 months to open• Permanent: 36 months to open
Hiring	<ul style="list-style-type: none">• 60% Minorities, 45% Women, 5% Veterans, 5% Persons w/ Disability
Vendor Sourcing	<ul style="list-style-type: none">• 26% MBE, 10% WBE, 2% DBE, 3% VBE
Infrastructure Improvements	<ul style="list-style-type: none">• Estimated to be \$75 million

Chicago Community Builder's Collective



Community Investment Program

Diverse
Participation

Loan Program

Crowdfunding

Ownership Parity

Thank You

Casino Public Safety – CPD Plan

Vision

The **Temporary Casino** is an exciting first chapter in Chicago’s casino experience. The Public Safety Plan centers around **People, Technology, Training, Traffic, and Community Engagement**.

Topics

People

Technology

Training

Traffic

Community

Highlights

- | | | | | |
|---|---|--|---|---|
| <ul style="list-style-type: none">• Police personnel responsible for the entire downtown area including the halo around the casino site• Bally’s security will control interior of the site and have some presence on the immediate exterior, while CPD will have jurisdiction over the exterior around site | <ul style="list-style-type: none">• CPD in coordination with OEMC will be adding additional License Plate Readers (LPRs) and Police Observational Devices (PODs) to the area• CPD coordinating with Bally’s on compatibility of technology | <ul style="list-style-type: none">• CPD coordinating with Bally’s and relevant city departments regarding critical incident response• Officers working around the casino site will be given additional training on safety matters generally attributed to casinos | <ul style="list-style-type: none">• CPD coordinating with CDOT, OEMC, and Bally’s to facilitate daily management of pedestrian and vehicular traffic• The Temporary Casino will utilize Traffic Control Aides (TCA’s) as necessary around the site | <ul style="list-style-type: none">• CPD will facilitate engagement with the community so that community partners have the opportunity to be involved with the entire safety process of temporary facility• CPD working with Bally’s to communicate with the community around the site regarding safety |
|---|---|--|---|---|